



YOUR ONE STOP HYDRAULICS SHOP

Industrial Hydraulics are proud to announce we are authorised Distributors of Dantal Cylinders. Dantal Cylinders are of superior quality but at an affordable price.



DANTAL HYDRAULICS PVT. LTD.
Total Solutions in Hydraulics

Dantal Hydraulics has been established since 1990 and today is the leading manufacturer of hydraulic cylinders & systems in India and is the preferred suppliers to Global OEM's.

SPECIFICATIONS

ALL CYLINDERS ARE DUAL PORT

- 🔧 **Bore & Stroke**
Bore Diameters
1.5", 2.0", 2.5", 3.0", 3.5", 4.0"
& 5.0"

Standard Stroke
6", 8", 10", 12", 16", 18", 20",
24", 30", 36", 48"
(Other stroke sizes are available on request)

- 🔧 **Pressure Rating**
Bore Size
1.5" – 5.0" = 210 bar (3000 PSI)

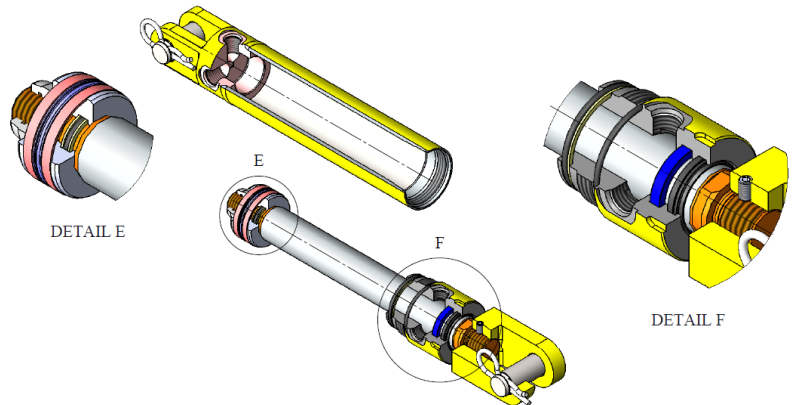

QUALITY

- 🔧 ISO9001-2008 certified by UL.
- 🔧 ISO14001:2004 & OHSAS 18001:2007 certified.
- 🔧 ISO 3834-2 for fusion welding
- 🔧 100% inspection & testing of all products.
- 🔧 Modern measuring instruments & equipment.
- 🔧 In house Salt Spray Chamber testing.
- 🔧 Fully intergrated ERP system of SAP.



SPECIAL CYLINDERS AVAILABLE ON REQUEST

PH: 07 3205 3612
18-20 WALTER CRES, LAWNTON QLD 4501
www.industrialhyd.com.au



YOUR ONE STOP HYDRAULICS SHOP

1 1/2" BORE HYDRAULIC CYLINDER

BORE x STROKE (inches)	PART NUMBER	ROD DIAMETER	CLOSED CENTRES	OPEN LENGTH	PORT SIZE	PIN DIAMETER	WEIGHT (kg)
1 1/2 x 6	DC 1 1/2 X 06	22mm 7/8"	393mm 15 1/2"	546mm 21 1/2"	9/16" UN O-Ring	19.05mm 3/4"	7.0
1 1/2 x 8	DC 1 1/2 X 08		444mm 17 1/2"	647mm 25 1/2"			7.3
1 1/2 x 10	DC 1 1/2 X 10		495mm 19 1/2"	749mm 29 1/2"			7.5
1 1/2 x 12	DC 1 1/2 X 12		546mm 21 1/2"	851mm 33 1/2"			7.8

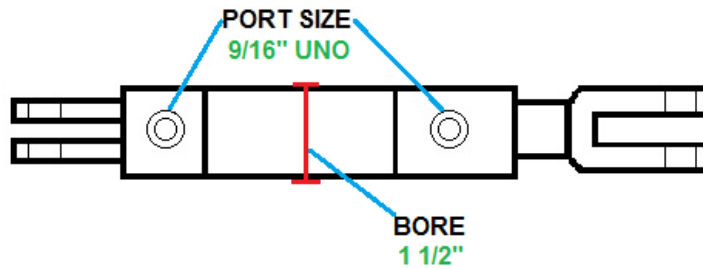
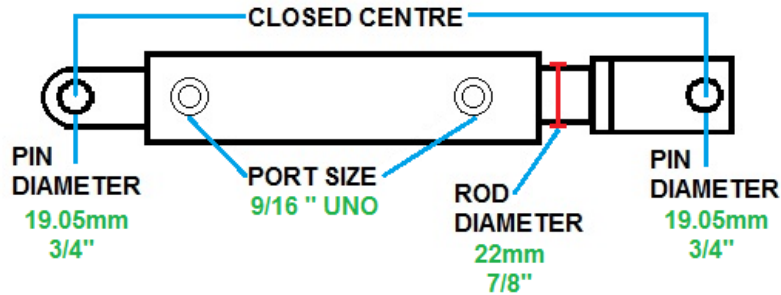



YOUR ONE STOP HYDRAULICS SHOP

2" BORE HYDRAULIC CYLINDER

BORE x STROKE (inches)	PART NUMBER	ROD DIAMETER	CLOSED CENTRES	OPEN LENGTH	PORT SIZE	PIN DIAMETER	WEIGHT (kg)
2 x 2	DC 2 X 02	32mm 1 1/4"	362mm 14 1/4"	413mm 16 1/4"	9/16" UN O-Ring	25.4mm 1"	6.6
2 x 6	DC 2 X 06		463mm 18 1/4"	616mm 24 1/4"			8.2
2 x 8	DC 2 X 08		514mm 20 1/4"	717mm 28 1/4"			9.0
2 x 10	DC 2 X 10		565mm 22 1/4"	819mm 32 1/4"			9.8
2 x 12	DC 2 X 12		616mm 24 1/4"	921mm 36 1/4"			10.6

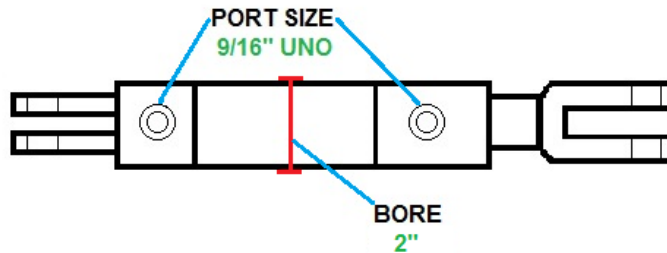
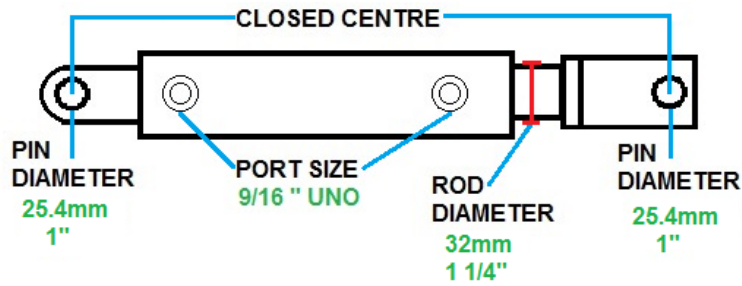



YOUR ONE STOP HYDRAULICS SHOP

2 ½" BORE HYDRAULIC CYLINDER

BORE x STROKE (inches)	PART NUMBER	ROD DIAMETER	CLOSED CENTRES	OPEN LENGTH	PORT SIZE	PIN DIAMETER	WEIGHT (kg)
2 ½ x 4	DC 2 ½ x 04	40mm 1 1/2"	413mm 16 ¼"	514mm 20 ¼"	3/4" UN O-Ring	25.4mm 1"	9.1
2 ½ x 6	DC 2 ½ X 06		463mm 18 ¼"	616mm 24 ¼"			9.8
2 ½ x 8	DC 2 ½ X 08		514mm 20 ¼"	717mm 28 ¼"			10.8
2 ½ x 10	DC 2 ½ X 10		565mm 22 ¼"	819mm 32 ¼"			11.9
2 ½ x 12	DC 2 ½ X 12		616mm 24 ¼"	921mm 36 ¼"			12.8
2 ½ x 16	DC 2 ½ X 16		717mm 28 ¼"	1123mm 44 ¼"			14.1
2 ½ x 18	DC 2 ½ X 18		768mm 30 ¼"	1225mm 48 ¼"			14.8
2 ½ x 20	DC 2 ½ X 20		819mm 32 ¼"	1327mm 52 ¼"			15.7
2 ½ x 24	DC 2 ½ X 24		921mm 36 ¼"	1530mm 60 ¼"			17.6
2 ½ x 30	DC 2 ½ X 30		1073mm 42 ¼"	1835mm 72 ¼"			20.6
2 ½ x 36	DC 2 ½ X 36		1225mm 48 ¼"	2139mm 84 ¼"			23.2
2 ½ x 48	DC 2 ½ X 48		1530mm 60 ¼"	2749mm 108 ¼"			29.1

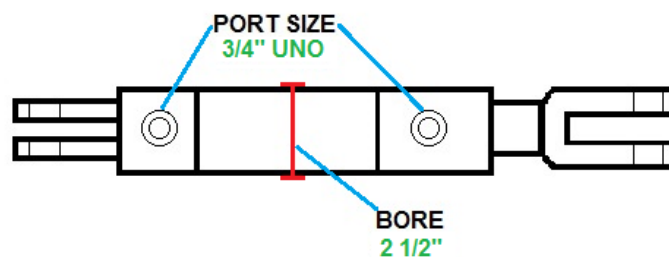
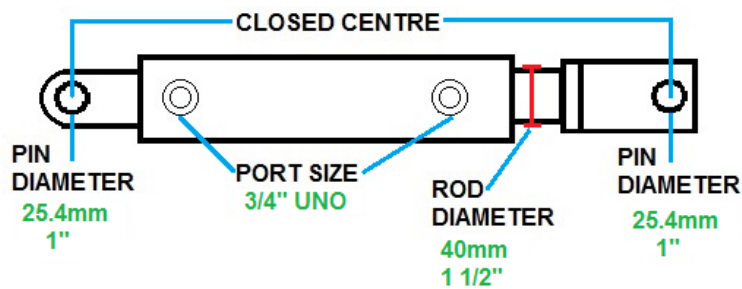



YOUR ONE STOP HYDRAULICS SHOP

3" BORE HYDRAULIC CYLINDER

BORE x STROKE (inches)	PART NUMBER	ROD DIAMETER	CLOSED CENTRES	OPEN LENGTH	PORT SIZE	PIN DIAMETER	WEIGHT (kg)
3 x 8	DC 3 X 08	40mm 1 1/2"	514mm 20 1/4"	717mm 28 1/4"	3/4" UN O-Ring	25.4mm 1"	14.5
3 x 12	DC 3 X 12		616mm 24 1/4"	921mm 36 1/4"			16.7
3 x 16	DC 3 X 16		717mm 28 1/4"	1123mm 44 1/4"			18.5
3 x 18	DC 3 X 18		768mm 30 1/4"	1225mm 48 1/4"			19.3
3 x 24	DC 3 X 24		921mm 36 1/4"	1530mm 60 1/4"			22.7
3 x 30	DC 3 X 30		1073mm 42 1/4"	1835mm 72 1/4"			26.4
3 x 36	DC 3 X 36		1225mm 48 1/4"	2139mm 84 1/4"			30.0
3 x 48	DC 3 X 48		1530mm 60 1/4"	2749mm 108 1/4"			36.9

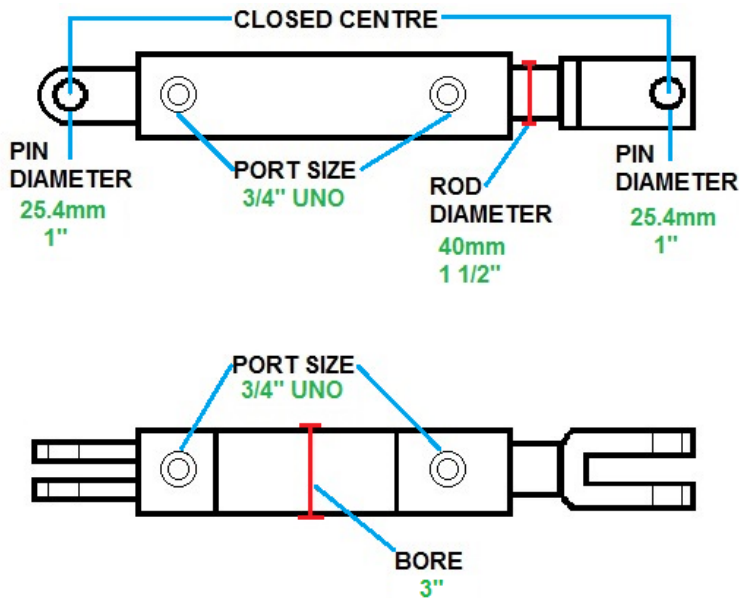



YOUR ONE STOP HYDRAULICS SHOP

3 1/2" BORE HYDRAULIC CYLINDER

BORE x STROKE (inches)	PART NUMBER	ROD DIAMETER	CLOSED CENTRES	OPEN LENGTH	PORT SIZE	PIN DIAMETER	WEIGHT (kg)
3 1/2 x 8	DC 3 1/2 X 08	45mm 1 3/4"	514mm 20 1/4"	717mm 28 1/4"	3/4" UN O-Ring	25.4mm 1"	19.4
3 1/2 x 12	DC 3 1/2 X 12		616mm 24 1/4"	921mm 36 1/4"			22.2
3 1/2 x 16	DC 3 1/2 X 16		717mm 28 1/4"	1123mm 44 1/4"			24.2
3 1/2 x 18	DC 3 1/2 X 18		768mm 30 1/4"	1225mm 48 1/4"			25.7
3 1/2 x 24	DC 3 1/2 X 24		921mm 36 1/4"	1530mm 60 1/4"			30.2
3 1/2 x 30	DC 3 1/2 X 30		1073mm 42 1/4"	1835mm 72 1/4"			35.0
3 1/2 x 36	DC 3 1/2 X 36		1225mm 48 1/4"	2139mm 84 1/4"			39.5
*3 1/2 x 48	DC 3 1/2 X 48		1530mm 60 1/4"	2749mm 108 1/4"			48.5

*SPECIAL ORDER ONLY

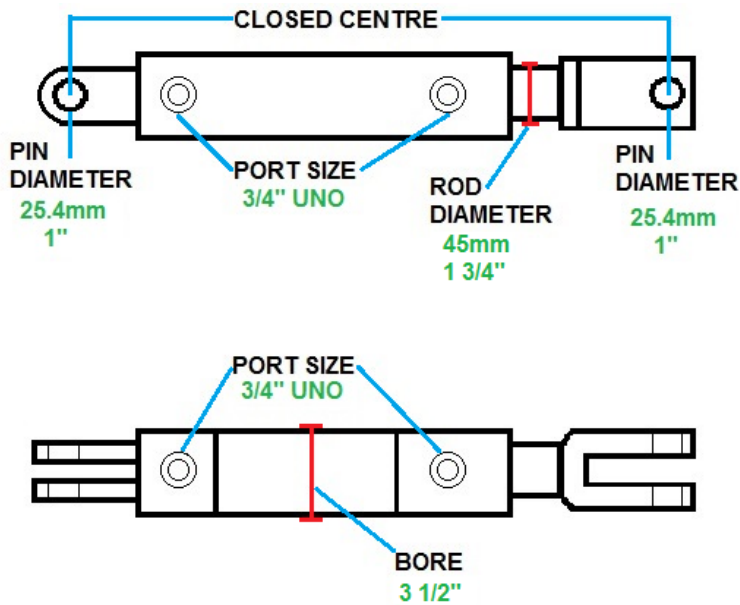



YOUR ONE STOP HYDRAULICS SHOP

4" BORE HYDRAULIC CYLINDER

BORE x STROKE (inches)	PART NUMBER	ROD DIAMETER	CLOSED CENTRES	OPEN LENGTH	PORT SIZE	PIN DIAMETER	WEIGHT (kg)
4 x 8	DC 4 X 08	45mm 1 3/4"	514mm 20 1/4"	717mm 28 1/4"	3/4" UN O-Ring	25.4mm 1"	22.0
4 x 12	DC 4 X 12		616mm 24 1/4"	921mm 36 1/4"			25.0
4 x 16	DC 4 X 16		717mm 28 1/4"	1123mm 44 1/4"			28.0
4 x 18	DC 4 X 18		768mm 30 1/4"	1225mm 48 1/4"			29.7
4 x 24	DC 4 X 24		921mm 36 1/4"	1530mm 60 1/4"			34.6
4 x 30	DC 4 X 30		1073mm 42 1/4"	1835mm 72 1/4"			39.0
4 x 36	DC 4 X 36		1225mm 48 1/4"	2139mm 84 1/4"			45.0
4 x 48	DC 4 X 48		1530mm 60 1/4"	2749mm 108 1/4"			55.0

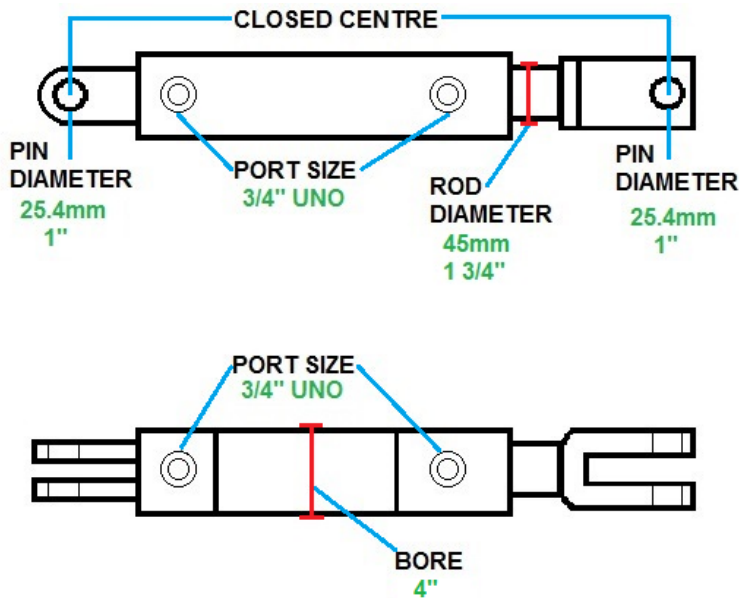



YOUR ONE STOP HYDRAULICS SHOP

5" BORE HYDRAULIC CYLINDER

BORE x STROKE (inches)	PART NUMBER	ROD DIAMETER	CLOSED CENTRES	OPEN LENGTH	PORT SIZE	PIN DIAMETER	WEIGHT (kg)		
5 x 8	DC 5 X 08	50mm 2"	514mm 20 1/4"	717mm 28 1/4"	3/4" UN O-Ring	25.4mm 1"	28.5		
5 x 12	DC 5 X 12		616mm 24 1/4"	921mm 36 1/4"			32.7		
5 x 16	DC 5 X 16		717mm 28 1/4"	1123mm 44 1/4"			36.9		
5 x 18	DC 5 X 18		768mm 30 1/4"	1225mm 48 1/4"			39.0		
5 x 24	DC 5 X 24	63mm 2 1/2"	921mm 36 1/4"	1530mm 60 1/4"			3/4" UN O-Ring	25.4mm 1"	53.0
5 x 30	DC 5 X 30		1073mm 42 1/4"	1835mm 72 1/4"					60.5
5 x 36	DC 5 X 36		1225mm 48 1/4"	2139mm 84 1/4"					68.2
*5 x 48	DC 5 X 48		1530mm 60 1/4"	2749mm 108 1/4"					83.2

***SPECIAL ORDER ONLY**

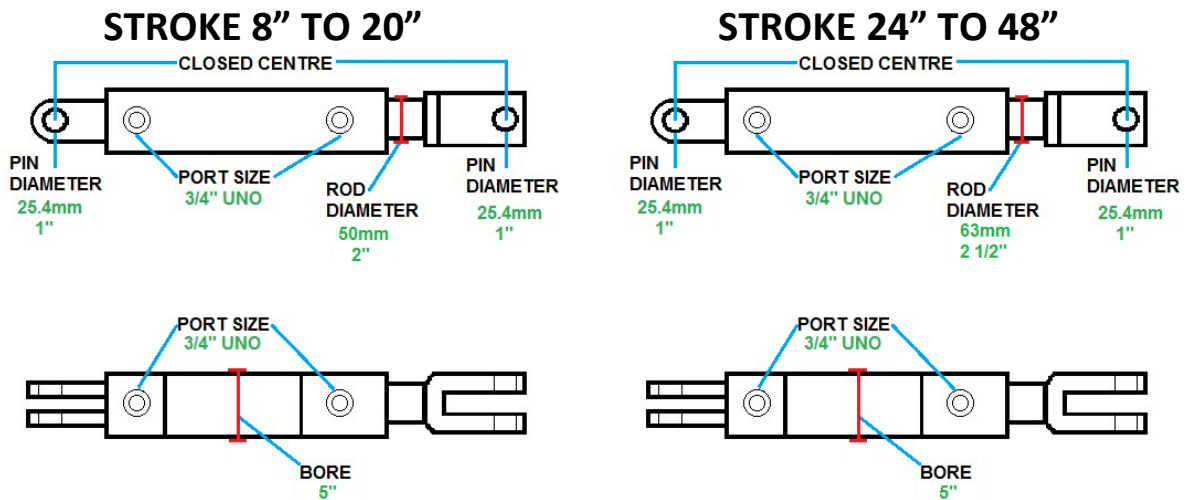



YOUR ONE STOP HYDRAULICS SHOP

TOPLINK INDUSTRIAL GRADE HYDRAULIC CYLINDERS

PART NO.	BORE DIA	STROKE	ROD DIA	CLOSE LENGTH	OPEN LENGTH	PORT SIZE	PIN DIA	WEIGHT
DC2 1/2 X 08TL	2 ½" 63mm	8" 203mm	1 ½" 40mm	20 ¼" 514mm	28 ¼" 717mm	3/4" UN O-ring	1" 25.4mm	10.8 kg
DC2 1/2 X 12TL	2 ½" 63mm	12" 305mm	1 ½" 40mm	24 ¼" 616mm	36 ¼" 921mm	3/4" UN O-ring	1" 25.4mm	12.8 kg

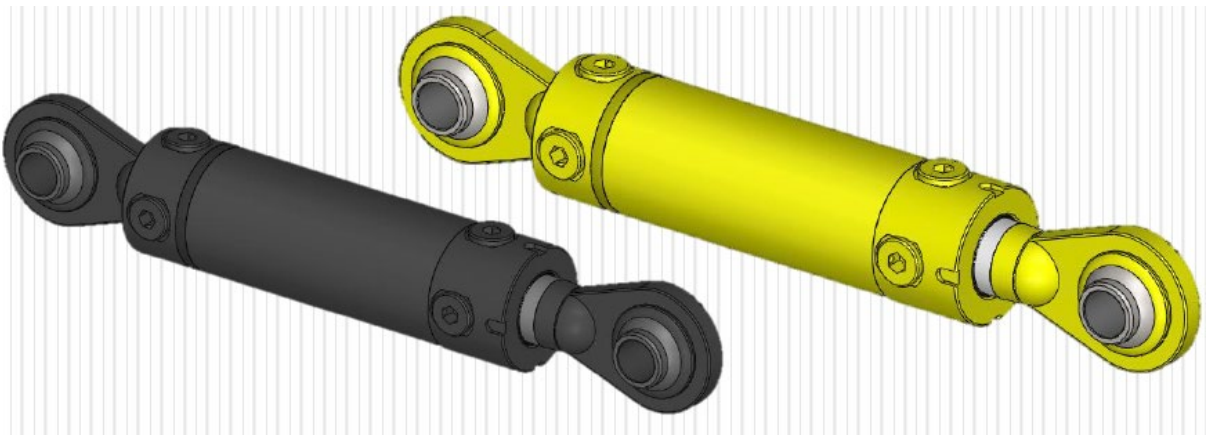

PH: 07 3205 3612
18-20 WALTER CRES, LAWNTON QLD 4501
www.industrialhyd.com.au



YOUR ONE STOP HYDRAULICS SHOP
SECTIONAL DRAWING

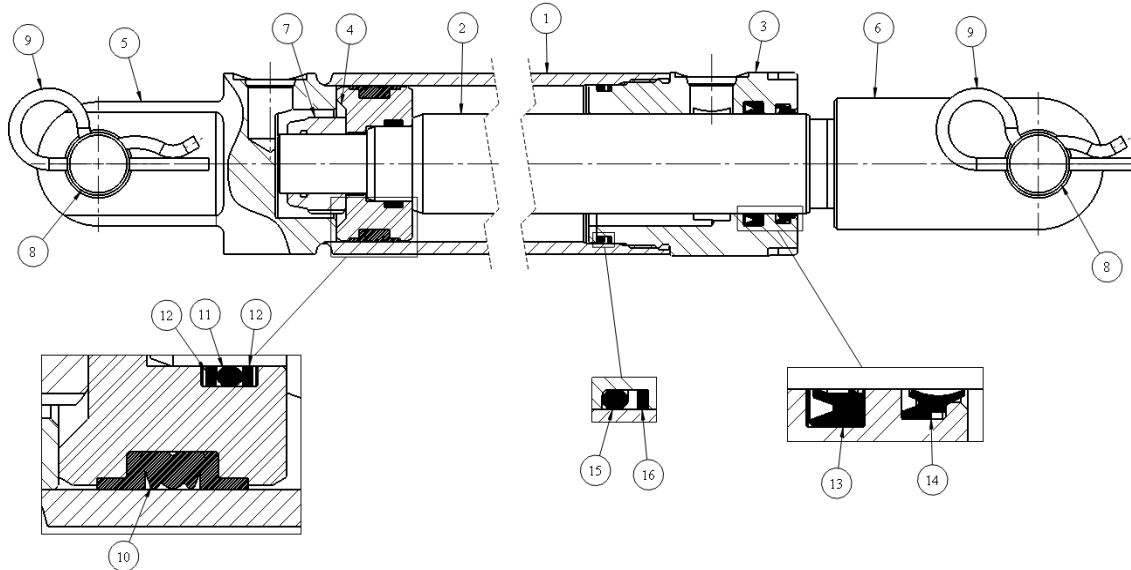

LOCATION:	PART:	DESCRIPTION:
1	CYLINDER TUBE	CDS ST52/E355 seamless steel tube, accurately honed to ensure smooth operation and extended seal life.
2	PISTON ROD	High precision grounded, EN8D/C45 round bars, toughened and induction hardened, hard chrome plated with deposit of 20-30 microns, tensile strength – 600 N/mm ² .
3	GLAND	Ductile cast iron - SG500/7, tensile strength - 500 N/mm ² .
4	PISTON	EN8D/C45 round bars, tensile strength - 650 N/mm ² .
5	REAR CLEVIS	EN8D/C45 round bars, tensile strength - 650 N/mm ² .
6	FRONT CLEVIS	EN8D/C45 round bars, tensile strength - 650 N/mm ² .
7	PISTON NUT	Gr 6 = nylock nut material UTS = 600N/mm ² .
8	CLEVIS PIN	EN24 – toughened, BS970 round bars, tensile strength - 750 N/mm ² .
9	BETA PIN	Spring steel for durability and ease of installation/removal.
10	PISTON SEAL	Double acting high pressure, heavy duty seal comprising an elastomeric profile seal ring, two back up rings & two guide rings. K-DAS piston seal.
11	PISTON O-RING	NBR O-ring, acrylonitrile-butadiene rubber (nitrile rubber).
12	PISTON BACK UP RING	PTFE back up ring, polytetrafluoroethylene, internal and external high pressure application, reciprocating and rotating movement, capable of large temperature fluctuations, static and dynamic suited.
13	ROD PRESSURE SEAL U-CUP	Double lip single acting seal with acetal polyamide back up ring for high pressure applications, abrasive and wear resistant, compensates deflections of piston rod, restricts air and dirt entry to system, suited to sudden load and high pressure, simple installation.
14	WIPER SEAL	Wiper seal ensures that foreign matter is not introduced into the system, PU material, compact design and ease of installation.
15	GLAND O-RING	NBR O-ring, acrylonitrile-butadiene rubber (nitrile rubber).
16	GLAND BACK UP RING	PTFE back up ring, polytetrafluoroethylene, internal and external high pressure application, reciprocating and rotating movement, capable of large temperature fluctuations, static and dynamic suited.

PH: 07 3205 3612

18-20 WALTER CRES, LAWNTON QLD 4501

www.industrialhyd.com.au

AUTHORISED DISTRIBUTORS FOR:



OTHER BRANDS INCLUDE:



CDS Hydraulic Tube



EDCA Refuelling Components



Filpro Filtration & Accessories



Deliflex Power Packs



Fox Pressure Switches



Hydraforce Cartridge Valves



M+S High Torque Low Speed



Hydraulic Motor



CBF Valves



Ronzio Gear Pumps and Hand Pumps



Molytec Performance Lubricants



and Chemicals



Ultraloc Industrial anaerobic threadlockers,

sealants retaining compounds



QT Fluid monoblock control valves



Earthhitch, Quickhitch and Tilt Valves

OTHER SERVICES INCLUDE:

Prompt in-house hydraulic hose replacement or repair

Authorised Banlaw nozzle repair by qualified technicians

EDCA nozzle repair by qualified technicians

Custom Hose Assembly Tags

Custom built powerpacks to suit all application

EATON WINNER EC210

EC210

EN853 2SN



# Part No.	DN	Hose I.D.		Hose O.D.		Maximum Working Pressure		Minimum Burst Pressure		Minimum Bend Radius		Weight	
		mm	in	mm	in	bar	psi	bar	psi	mm	in	kg/m	lb/ft
EC210-04	6	6.4	0.25	15.0	0.59	400	5800	1600	23200	100.0	3.94	0.38	0.26
EC210-06	10	9.5	0.38	18.9	0.74	330	4800	1320	19200	130.0	5.12	0.54	0.36
EC210-08	12	12.7	0.50	22.2	0.87	275	4000	1100	16000	180.0	7.09	0.64	0.43
EC210-12	19	19.0	0.75	29.2	1.15	215	3125	860	12500	240.0	9.45	0.93	0.62
EC210-16	25	25.4	1.00	37.2	1.46	165	2400	660	9600	300.0	11.81	1.29	0.87

Construction

- Synthetic rubber tube
- Double wire braid reinforcement
- DURA-TUFF rubber cover
- Green ink transfer layline

Agency Listings

MSHA approved

Operating Temperature Range

-40°C to + 100°C

Approved Fittings

TTC series

Eaton Field Attachable

Winner 2-piece (non-skive)

Application

- Hydraulics system service with petroleum and water-based fluids
- General industrial service